

# CARBON STEEL BALL PIVOT WELDHAWN

## DN 15-50 PN 40

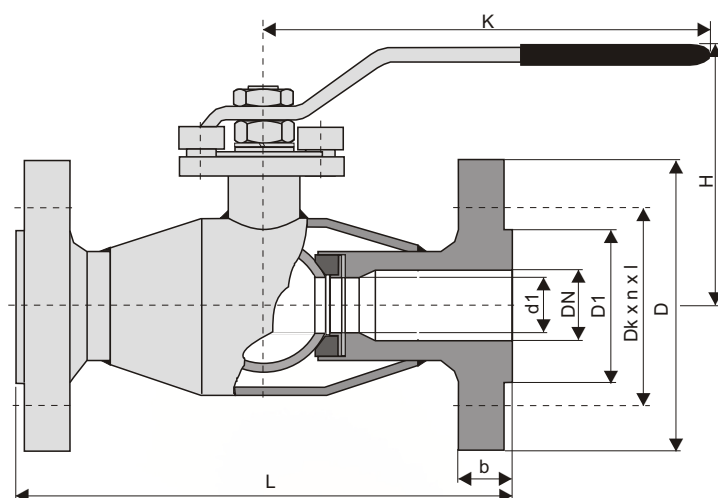

3.240.



vtsz.8481808100

**JOINING SIZE:**

DIN 2501 (flanged)

**CONSTRUCTION OF LENGTH:**

MSZ EN 558-1 FTF 1 (DIN 3202-F1) flanged

**GRADE OF SEEPAGE:**

MSZ 4563-1983. 3. 1.

DIN 3230/3 BO 1.

**AREA OF APPLICATION:**

For cold and hot water, steam and for liquids to the material of the parts in the following range shown in the operational pressure-temperature diagram

| DN | d1 | D1  | Dk x n x l   | D   | L   | b  | H   | K   | kg/db |
|----|----|-----|--------------|-----|-----|----|-----|-----|-------|
| 15 | 15 | 45  | 65 x 4 x 14  | 95  | 130 | 16 | 95  | 160 | 2,3   |
| 20 | 15 | 58  | 75 x 4 x 14  | 105 | 150 | 18 | 95  | 160 | 2,9   |
| 25 | 20 | 68  | 85 x 4 x 14  | 115 | 160 | 18 | 115 | 185 | 3,5   |
| 32 | 25 | 78  | 100 x 4 x 18 | 140 | 180 | 18 | 120 | 185 | 5,2   |
| 40 | 32 | 88  | 110 x 4 x 18 | 150 | 200 | 18 | 140 | 200 | 6,5   |
| 50 | 40 | 102 | 125 x 4 x 18 | 165 | 230 | 20 | 145 | 200 | 10    |

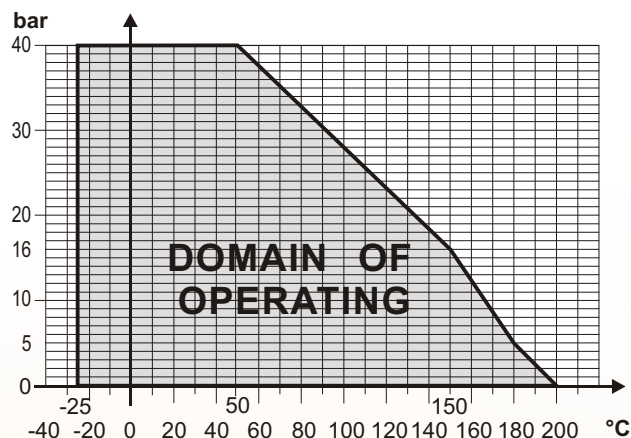

| welded with extension piece |    | DN         | D2 x s | L   | kg/db |
|-----------------------------|----|------------|--------|-----|-------|
|                             | 15 | 20 x 2     | 210    | 0,9 |       |
|                             | 20 | 25 x 2,5   | 230    | 0,9 |       |
|                             | 25 | 30 x 2,6   | 230    | 1,2 |       |
|                             | 32 | 38 x 2,6   | 260    | 1,6 |       |
|                             | 40 | 44,5 x 2,6 | 260    | 2,7 |       |
|                             | 50 | 57 x 2,9   | 300    | 3,5 |       |

**MATERIALS OF MAIN PARTS:**

| Specifying    | Material quality (~)                |
|---------------|-------------------------------------|
| Case          | St. 37.0 DIN 1629                   |
| Ball DN 15-25 | 1.4541 MSZ EN 10088-1               |
| Ball DN 32-50 | 1.4301 MSZ EN 10088-1               |
| Seat          | PTFE + 25% Cg                       |
| Shaft         | 1.4021 MSZ EN 10088-1               |
| Shaft sealing | 2 db PTFE ring<br>1 db FPM "O" ring |

| threaded |    | DN      | D3 | l   | L   | kg/db |
|----------|----|---------|----|-----|-----|-------|
|          | 15 | Rp 1/2" | 10 | 85  | 0,8 |       |
|          | 20 | Rp 3/4" | 10 | 95  | 0,8 |       |
|          | 25 | Rp 1"   | 12 | 105 | 1   |       |
|          | 32 | Rp 5/4" | 12 | 130 | 1,2 |       |
|          | 40 | Rp 6/4" | 16 | 180 | 2,5 |       |
|          | 50 | Rp 2"   | 16 | 190 | 3   |       |

**TORQUE:**

